

SensePatch

SensePatch is a patch pump used for tubeless subcutaneous drug delivery.

The micro pump device is self-adhesive and has an integrated auto-inserter for the needle.

This ensures an easy, discreet and less stressful needle insertion and initiates the drug delivery process.



Sensile Medical AG

Solothurnerstrasse 235 | CH-4600 Olten | Switzerland
Phone + 41 62 209 71 00 | Fax + 41 62 209 71 01
bd@sensile-medical.com | www.sensile-medical.com

SMART, SIMPLE, SUSTAINABLE

SensePatch Benefits

- Easy-to-use with a low number of handling steps – Human Factors proven*
- Highly accurate dosing
- Variable and pre-programmed dosing regimens
- Automatic needle insertion and retraction – patient never sees the needle (up to 30 G)
- Smart sensor technology to reduce human errors and risks
- Utilizes standard 3 ml cartridges, other sizes possible
- Simple and comprehensive data download optional possible
- Design-inherent free-flow prevention
- Semi-disposable device, very cost-effective
- Basal and/or bolus profile

Different dosing regimens

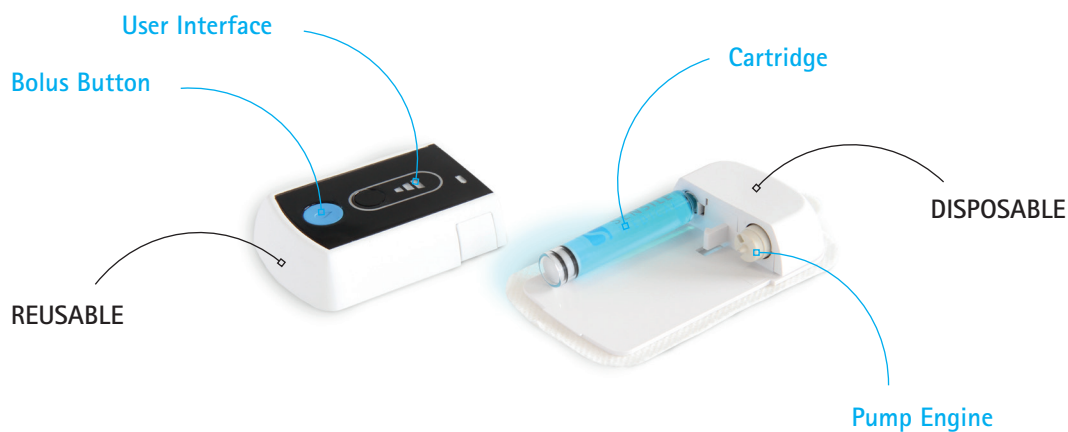
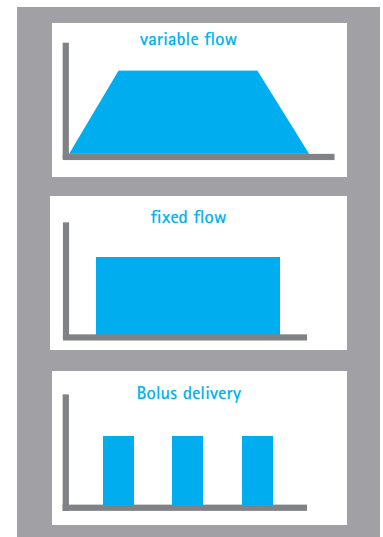

Technical details	Drug viscosity	
	1 mPas (cP)	> 20 mPas (cP) up to 100 mPas
Max. flow rate**	10 ml/min	< 70 ml/h
Needle diameter**	24-30 G	24-27 G
Max. needle length**	12 mm	12 mm
Further details		
Drug/filling volume	3 ml	
Pump size / delivery increment	2-5 µl	
Feed pressure	1.5 bar	
Dimension (LxWxH)	98 x 52 x 8 mm	
Weight (without drug container)	72 g	

* Data on file at Sensile Medical.

** Operating features are highly dependent on the characteristics of the liquid. Max. can be achieved with liquids with low viscosities.